

Down lite ULTRA

PROJECT: _____

TYPE: _____

SOURCE: _____

NOTES: _____

SPECIFICATIONS



LED Chip	Cree CXA 2540 field replaceable LED board
Luminaire Output	5000 Lumens @ 1400mA (52 watts) , Delivered from Luminaire with unobstructed beam.
Lumens Per Watt	90 Lumens minimum @ 52 watts, Delivered from Luminaire with unobstructed beam
CRI (3000K)	80 Standard, 90+ Optional
Colour Temperatures	2700K, 3000K, 4000K
Beam Angles	13, 22, 33, 51
Ingress Protection	IP66
Warranty	Electronics = 5 years Body Aluminium = 5 years
Standards	BS/EN 60598.2.2 cUL 1598 CE

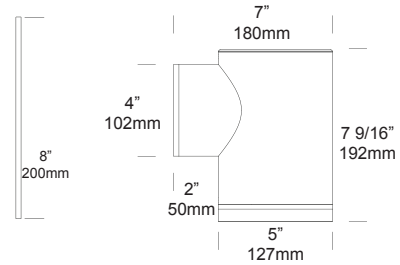

PRODUCT CONFIGURATION

Please fill in appropriate codes into boxes provided

Cat. No. DL/U

Luminaire	Power	Material/ Finish	Beam	Colour	Accessories
<input type="text" value="DL/U"/>	<input type="text"/>	<input type="text"/>	<input type="text"/>	<input type="text"/>	<input type="text"/>
SR SERIES REMOTE R RETRO, 120-277vac INPUT		ALUMINIUM EBK BLACK EBZ BRONZE EOGR OLIVE GREEN EWH WHITE EWB WHITE BIRCH EDG DARK GREY ESTAR SILVER STAR ECT CORTEN	22 22° 33 33° 51 51° 13 13° Requires Lens Ring extension	2 2700K 3 3000K 4 4000K 39 3000K, 90+ CRI	HCL/U HEX CELL LOUVER SNT/U SNOOT GG/U GLARE GUARD GS05 GLARE SHIELD LF FROSTED LENS WP/U ULTRA WALL PLATE CJK CABLE JOINT KIT

SERIES REMOTE:
Constant current driver (included). Fixture require 37vdc @ 1400mA maximum. 0-10 volt dimming.

RETRO 110-277vac DRIVER:
Constant current driver (included). Input: 120, 240, 277 volts. Output: 60 watts total 37vdc @ 1400mA 0-10 volt dimming.

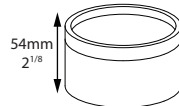

ADDITIONAL COMMENTS: _____

LUMINAIRE CONSTRUCTION

CNC machined from one of the following metals:

Body - solid high corrosion resistant 127mm (5") aluminium rod.
 Base - high corrosion resistant 127mm (5") x 3.18mm (1/8") aluminium tube.
 Finished with chromate substrate, Epoxy layer and a UV resistant polyester powder coat colour.
 Fixings and Mechanism - made from 316 Stainless Steel

Colours:

Black, Bronze, Silver Star, White, Birch, Olive Green, Dark Grey, Corten.

Step Lens:

12mm (1/2") Extra clear, low iron, shatter resistant glass.
 Lifetime warranty

Gaskets:

Silicone, iron impregnated 220°C (428°F)

Cable:

Water resistant rubber

Mounting:

The mounting plate is fixed to the surface using three stainless screws. The luminaire is then fixed to the mounting plate

Luminaire Weight:

6kg (13lbs 4oz)

ACCESSORIES

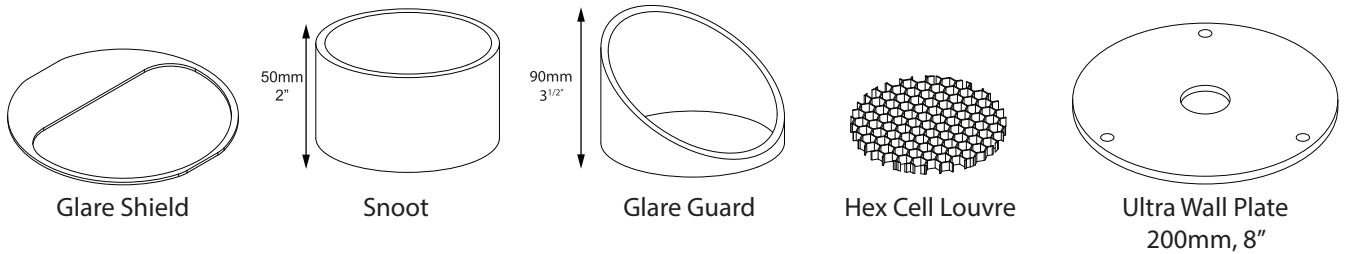

BEAM ANGLES

High efficiency Reflectors. Feild replaceable

IES files available for download: hunzalighting.com/downloads

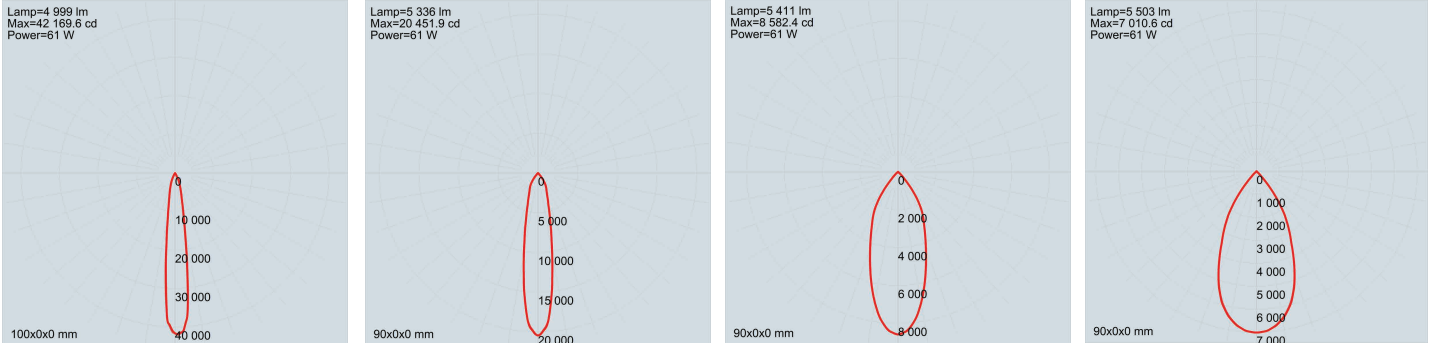

WIRING GUIDE

Available for download: hunzalighting.com/downloads

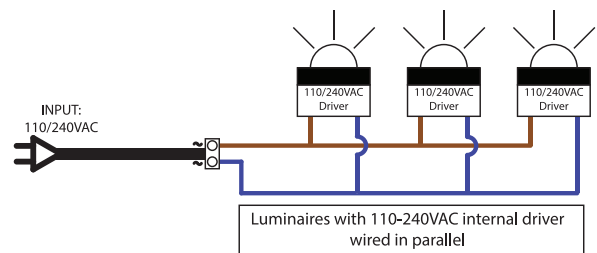
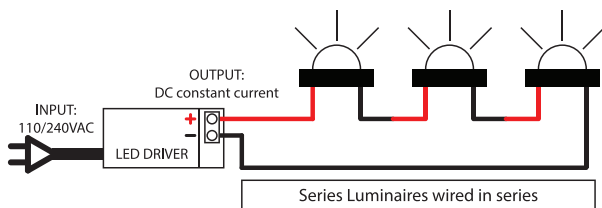

Diagrams are a guide only, wire colours and polarity may change depending on fixture and country